



# dialogue

Newsletter Summer 2021



dundee institute  
of architects

## Dundee Institute of Architects Annual Awards and Dinner 2021

After the cancellation of the 2020 awards due to the Covid-19 Pandemic, we are delighted to announce that our annual Awards Dinner will take place on Thursday 18th November at the Invercarse Hotel, 371 Perth Road, Dundee.

Please keep a look out for the Awards entry email dropping into your in-boxes and we look forward to seeing what you have all been busy doing over the last couple of years.

### Awards Categories are:

**Best on Drawing Board Award.**

**Best Use of Timber Award.**

**Best Interior Design Award.**

**Best Group of Housing Award.**

**Best Use of Stone Award.**

**Best Commercial / Non-domestic Award.**

**Best Small Project – Domestic Award.**

**Best Small Project – Non-domestic Award.**

**Ambassador Award**

**Best Rehab/Regeneration Award.**

**Best New House Award.**

**Supreme Award.**

## DIA Council 2021-2022

The elected DIA Council seeks to represent and support all members within its boundary. To do this effectively Council requires that members actively interact providing a mutual support network for all. DIA Council represents you. Please do not hesitate to contact any member of Council if you feel that they can be of assistance.

President: **Ian Muir:** [ian@mwparchitects.co.uk](mailto:ian@mwparchitects.co.uk)

Vice President: **Rodger Brunton:**  
[rodger@bruntondesign.com](mailto:rodger@bruntondesign.com)

Treasurer: **Christine J Palmer:**  
[Christine.j.palmer.architect@gmail.com](mailto:Christine.j.palmer.architect@gmail.com)

Secretary: **Fraser Middleton:** [fraser@arktx.co.uk](mailto:fraser@arktx.co.uk)

Past President: **Jon Frullani:**  
[jon@jonfrullaniarchitect.co.uk](mailto:jon@jonfrullaniarchitect.co.uk)

Council Representatives:

**Ryan Cathro:** [ryan.cathro@nrsarchitects.com](mailto:ryan.cathro@nrsarchitects.com)

**Peter Gunning:** [peter@archidarchitects.co.uk](mailto:peter@archidarchitects.co.uk)

**Alan Macdonald:** [alan@atelier-m.co.uk](mailto:alan@atelier-m.co.uk)

**Diarmid McLachlan:** [Diarmid.McLachlan@fife.gov.uk](mailto:Diarmid.McLachlan@fife.gov.uk)

**John Purves:** [John.Purves@fife.gov.uk](mailto:John.Purves@fife.gov.uk)

**Jenni Shanks:** [JShanks001@dundee.ac.uk](mailto:JShanks001@dundee.ac.uk)

**Gary Sinclair:** [gary@garysinclairarchitecture.com](mailto:gary@garysinclairarchitecture.com)

**Kerry Smith:** [kerry@kerrysmitharchitects.co.uk](mailto:kerry@kerrysmitharchitects.co.uk)



**It is a privilege to have been elected to serve as the President of DIA at our AGM in March 2021. It is an exciting & a slightly daunting prospect to be entrusted to represent & to promote our local profession in the year ahead.**

**Thanks to the team at Muir Walker Pride for their support & generosity in allowing me to take on this opportunity.**

I also would like to thank our outgoing President & our Committee members for all their hard work over the previous year.

The Dundee Institute of Architects belongs to you, our members. As President I would like to encourage as much engagement between our members and our Committee as possible. The DIA is an excellent forum for you to express your views on issues which matter & to help make a difference for our profession locally. Please let me, or any of our Committee members know if there is anything you wish to bring to the table.

It has been a traumatic year for many of us, however, despite the pandemic it has been a busy year for the DIA Committee who have continued their hard work on our members behalf. Not being able to physically meet up has been frustrating, however the committee has embraced digital communication to ensure that DIA business has continued as normally as possible.

One of the more visible changes in the last year has been the development of a new DIA website providing a fresh up to date face to the world. Please visit it & our social media presence on Facebook & Twitter for the latest DIA news, events & awards.

The DIA held seminars with Dundee City Council on Regulation changes and met with Dundee City Council Building Control regularly to discuss relevant issues around the pandemic. We also held a virtual workshop with 3rd and 4th year Architecture students of the University of Dundee, Duncan of Jordanstone students.

Last year the DIA sponsored student prizes awarded to University of Dundee School of Architecture including



## Presidents Column

**Ian Muir RIAS RIBA  
Dundee Institute of Architects**

Best Final Year Student. We look forward to seeing the student work, assessing & to the prize giving again this year.

The DIA along with the RIAS are working to resurrect the Martin Jones Scholarship for a student of Architecture at Duncan of Jordanstone.

Continuing the education theme, the RIAS is re-establishing an Education Working Group & the DIA looks forward to developing the relationship between the profession & the Schools of Architecture. If you have experience employing graduates or are a student, please provide us your concerns so that we can ensure that your voice is heard by Scottish Universities.

DIA Council members continue to be heavily involved with the RIAS and are represented on all Committees and assisted with the appointment of the new CEO for the RIAS.

We have continued to run a regular article in 'The Courier, Beautiful Homes' supplement advocating the benefits of using an Architect & we are grateful that the Courier & Jack McKeown in particular, continue to support the DIA and the work of their members, most recently publishing the result of our first ever Sustainability Design Award.

The DIA's well compiled annual magazine DIALOGUE continues in its digital format. It is issued to all professional and student members showcasing the great architecture carried out in our area.

It reflects on the activities of the DIA whilst proving interest and inspiration.

Unfortunately, Dundee Doors Open Day event was not able to take place last year & we look forward to re-establishing it when Covid-19 restrictions allow.

Looking forward, the DIA committee is working on re-establishing our winter CPD programme with a particular focus on sustainability. The DIA has been planning the relaunch of 'Creative Spaces' under a new format for secondary school pupils & we are also planning to mark COP 26 within our Chapter area. We look forward to sharing more details about these events in due course.

The DIA annual awards dinner will take place in November & we look forward to having fun celebrating the extravagance of creativity and talent in our Chapter area.

The signs are that the year ahead will be better than the last. Let us hope that it brings some stability to our lives and businesses and that our friends and family stay safe. Socially the last 14 months has been miserable and thirsty for many, and I for one look forward to meeting fellow members and participating in the (non-virtual) DIA pub quiz later this year!





## DIA Sustainability Awards 2021

**This is the first year the DIA have run a sustainability award, and we hope to include this as a permanent feature when the full DIA Awards recommence in 2022.**

The DIA are liaising with the RIAS and other Chapters to deliver a series of events for the COP26 Conference throughout the country to bring awareness of the impact of rising water levels on our coastal cities, towns and rural areas.

For this we are developing architectural cycle routes, shopfront exhibitions and will be preparing some beach messaging.

Dundee is to be the main Climate Beacon focus within our Chapter area and we have joined Dundee's COP26 Working Group who are co-ordinating a city wide

approach. There is going to be a launch event at Slessor Gardens on Sunday 26th September of which the DIA will be there with a stall to promote sustainable architecture.

We are currently preparing a brief for a competition to design the stall from recycled materials and this will go out to our members and the students at DJCAD for design entries. The winning entry will be constructed for the launch event and then exhibited within a shopfront until mid November.

The DIA are also preparing a series of Sustainability themed CPD events over the 6 week period culminating in a half day conference. These events will be open to the wider public and will also be promoted through the Dundee COP26 website list of events. We hope these events will raise many questions and discussions as to

what the Architectural profession can do to reduce the threat of the climate crisis.

We will be putting out a questionnaire in the coming weeks to get this discussion started.

If any of our members have any suggestions for talks and other events that we should be doing in the lead up to and during the COP26 conference please do not hesitate to contact us at [events@dia-architects.com](mailto:events@dia-architects.com)

Our next DIA Sustainability Group meeting will be on Monday 5th July at 6pm via Zoom if you would like to join in and help out with our events.

**Kirsty Maguire Architect Ltd is winner of the inaugural DIA 2021 Sustainability Award with the Urban Woodland Passivhaus Home.**



Set in the formerly landscaped grounds of Invergowrie House in Dundee, this new family home is nestled within mature trees and looks out over the Tay Estuary. Timber and zinc clad reflect the woodland setting and the ever-changing light on the nearby water. The main living spaces are at first floor to take advantage of the long views to the landscape while maintaining the privacy of the neighbours.

Influenced by the history of the neighbouring Invergowrie House, it is a contemporary home that respects its listed neighbour as well as having its own strong identity.

As well as meeting the passivhaus standard, it has an 'eco' low impact construction. It has been built using eco friendly wood based insulation and using a timber structure. Hence, it is low embodied energy and is low carbon and low energy in use. Cladding is Scottish larch and recyclable, long lasting zinc. The small energy needs of the house are powered by PV panels and an air source heat pump, further reducing the environmental impact in use.

**Grounds of Invergowrie House,  
Dundee DD2 1UA**

**Kirsty Maguire  
Kirsty Maguire Architect Ltd**

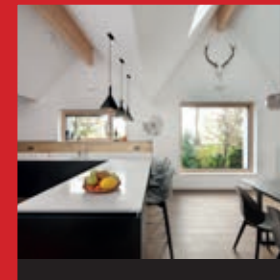

## Urban Woodland Passivhaus

# WINNER





## Ninewells Community Garden

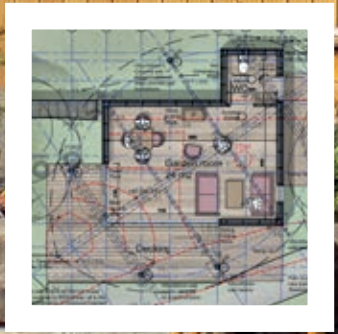

The Leaf Room is inspired from a natural form of a folded leaf – using a green roof overhanging a rectangular timber box underneath.

The main aim of the brief was to create to provide a safe, accessible, and inclusive environment for gardening activities. Amongst its numerous functions it has been an educational facility for children; hospital staff for meetings etc; the community garden staff and volunteer as a main office, living room, lunch space & shelter; an Artist’s studio; and a performance space.

The leaf room is extremely environmentally conscious and is constructed primarily in Natural Scottish Timber using Douglas Fir and Scottish Larch. The building is uniquely 100% “off grid” not requiring any service connections, contains a wood burning stove and rainwater is harvested from the roof and collected via 2 large containers to help water the garden. Since its opening in 2016 the client has installed an accessible WC and electricity for lighting and power.

The Leaf Room received a commendation from Dundee Civic Trust 2017 for outstanding contribution to the Dundee Townscape, and a Scottish Civic Trust ‘My Place’ Award in 2018 for the best community space in Scotland.

**The Leaf Room,  
7 Tom McDonald Avenue,  
Dundee DD2 1NH**

**Jonathan Reeve,  
Voigt Architects Limited**



This luxury detached countryside dwelling house was designed for a young family to be as energy efficient and sustainable as possible.

The building adopts a 'fabric first' approach that prioritises sustainable use of materials and ways of working, avoiding superficial 'eco-bling'. It concentrates on constructing an efficient building envelope. A well-insulated timber framed building envelope featuring glulam beams, triple glazed composite windows and a deliberately restricted palette of local building materials was utilised.

A ground source heat pump encompassing over a mile of underground collector pipes feeds an underfloor heating system over both floors. 28 photovoltaic solar collectors located on the south facing garage also assist in reducing operating costs.

The water source is brought from a local spring and reduced water flow sanitaryware has been installed in all Bathrooms and Ensuites to minimise water usage. A raised berm SUDS scheme dealing with all surface water on site is located within the garden to ensure that the local clay soil can accommodate the designed water run-off.

An extensive fire-fighting pond was installed which also provides an additional botanical attribute cultivating a healthy environment for a spectrum of wildlife species.

A local Design Team and Contractor were appointed to carry out the works.

**Detached Family Home, Redmyre,  
Perthshire DD2 5LH**

**Fraser Middleton  
ARKTX Chartered Architects**



## Detached Family home





## Easter Fernie School House

This house renovation project saw the creation of a new, near off-grid home within the shell of a former school house just outside Cupar.

We were keen to help our clients extend and prolong the life of the building as well as upgrading it by making it as energy efficient as possible. The old single glazed windows were replaced and the thermal envelope of the building improved.

At the front a new larch clad extension was added allowing for more generous living space. A larch framed sun room was also built off the kitchen with direct access onto the garden. Losing the central staircase created a large open plan living, dining space in the heart of the home with the kitchen at one end and an additional separate living room at the other end.

A spacious bathroom and store were built in the area previously taken up by the staircase and a new single bedroom/study was added alongside the existing two bedrooms.

Thermal and photovoltaic panels have been installed which combined with a new biomass boiler supply all of our clients domestic energy and hot water requirements.

The property also has it's own private water well, which with the installation of a pump and filter makes the house almost self-sufficient.

**Easter Fernie School House,  
Cupar KY15 4NA**

**Fermin Beltran  
Fife Architects**



## Longforgan Primary School

Longforgan Primary School involved the refurbishment and new build extension of a Grade B listed school within Longforgan Conservation Village, and incorporates sustainable initiatives including air source heat pumps, MVHR, roof mounted photovoltaic panels, upgrade of existing listed building fabric thermal performance; EPC rating A.

The resulting school form is designed around a central play courtyard, creating a building that is easy to understand and navigate. The new teaching block with its pitched roof creates an airy and light environment in which to learn. Flexible, semi-open plan teaching spaces are accessed from a central circulation spine which also functions as breakout space and additional informal teaching space.

The existing listed building has been reconfigured to provide a more efficient layout, with upgrades to building fabric thermal performance, stonework repairs, replacement roof, floors and windows. The completed extension and retrofit of the historical listed school building means it will continue to be part of the community for years to come.

Longforgan Primary School,  
66 Main Street, Longforgan,  
Dundee DD2 5EU

**Yvonne Roddie, Senior Architect**  
ECD Architects





## Intelligent Growth Solutions Ltd

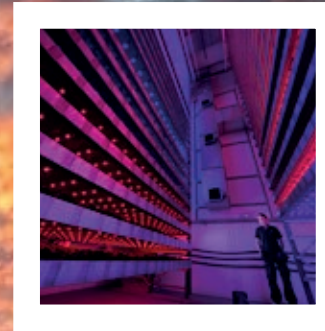

Intelligent Growth Solutions Ltd appointed AMCA Architects in 2015 to explore options for a unique crop research and production facility at the James Hutton Institute, Invergowrie.

The brief was to develop proposals for a unique structure which that would have a controlled internal environment for the installation of 4 vertical growth towers with a clear height of 9.2m. Each tower has a 40sq.m. footprint and a growing area of 312sq.m.

The facility uses advanced LED lighting, air flow controls, closed loop irrigation systems and no pesticides to grow crops in a mechanised indoor process for 365 days a year. Each growth module holds racks of trays suitable for growing a range of fast-growing herb, leafy greens and vegetables.

AMCA Architects have designed a scalable, sustainable modular structure which comprised an exoskeletal steel frame with composite panels to walls and roof, fixed internally to achieve a clear flat shell. The footprint extends to 663sq.m. To include ancillary servicing areas for planting and harvesting of crops.

The first phase was constructed in 2017 is the first Vertical Farm in Scotland.

The facility is used by IGS as demonstrator and has enabled the rollout of their innovative vertical farm technology nationally and globally.

**Intelligent Growth Solutions Ltd,  
Crop Research and Production  
Facility, Intelligent Growth Solutions,  
Invergowrie.**

**Sandy McAllister  
AMCA Architects**





## Tentsmuir NNR Education Pavilion

This pavilion was commissioned to create a welcome to the NNR, a gathering and learning hub and as a shelter in poor weather. The roof shape is reminiscent of a bird wing in flight, the sail of a boat, the historic tents that gave Tentsmuir its name and the ever shifting dunes themselves. The site has been carefully chosen to minimise the impact of a build on the fragile landscape and habitat. It was constructed from local materials that are non-toxic, recyclable and/or reusable. It is also designed for deconstruction at the end of its life – leaving no trace.

It was opened in June 2019 by a piper leading the local school children into the building, followed by the local MP, Councillors, SNH staff and the local community. Open 24/7, it is also always busy at weekends with the public visiting, picnic-ing, taking in view and enjoying the interpretation boards. It starred on BBC Autumnwatch in 2020 with filming based there for the duration of the programme. The pavilion was also included in the Scottish Natural Heritage 'Biodiversity Design with Nature' exhibition in September 2016, part of the Year of Architecture, Building and Innovation 2016.

**Tentsmuir NNR Education Building,  
Fife**

**Kirsty Maguire  
Kirsty Maguire Architect Ltd**

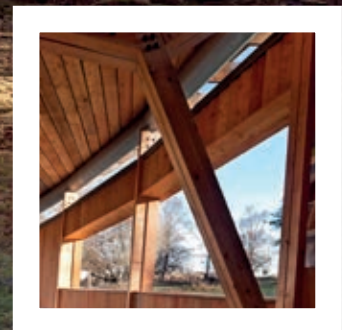
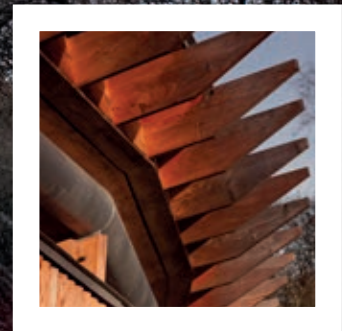



## Invercarse Hotel

This 24 bedroom extension to the popular Invercarse Hotel included a wedding suite, disabled access rooms and a sustainable future for the hotel.

The development encompasses both environmental and social sustainability through architecture that is energy-efficient, enduring and meets a sustainable identified need.

The design adopted a well-insulated building envelope orientated on an east/west access in order to optimise the southern exposure to the sun path and potential solar gain. The 96 photovoltaic solar collector panels ensure significant savings to running costs for the whole hotel and contribute to a 239,000kg Carbon saving over 20 years.

The building is sunk into the topography to protect the north, east and west elevations. Reduced water flow sanitaryware has been installed in all rooms. Daylighting in communal areas was an important consideration in order to minimise the use of artificial lighting with clerestory glazing in the upper corridor being a particularly attractive feature. All communal spaces have also been equipped with PIR activated lighting.

Within the extended car parking area four new electric charging points for vehicles have been installed.

A local Design Team and Contractor were used to execute the works.

**Invercarse Hotel, 371 Perth Road,  
Dundee, DD2 1PG**

**Fraser Middleton  
ARKTX Chartered Architects**





## Sanna House



The design for a new kitchen living extension to the existing house features a number of different techniques to maximise use of locally sourced timber.

A self-developed design for a 250mm thick wall cassette fabricated onsite from two 95mm timber frames connected with a 45mm central perimeter frame and faced with 12mm breathable sheathing board is then fully dry pump filled with recycled newspaper insulation.

A uv-façade breather membrane followed by installation of locally sourced (and very locally milled) open boarded, horizontal Scottish larch cladding forms the structures external rainscreen.

Installation of internal air-tightness membranes to a service void ensure the u-value of the wall panel is unaffected by service installations located completely inside the air-tight internal skin of the structure.

The main roof span of up to 5.75m is carried on locally sourced timber I-joists combining both small section Scottish timbers and OSB flange boarding (fabricated from a forestry bi-product), to reduce overall timber quantity and maximise proportional use of locally grown timber in the building structure.

Sheep's wool insulation is used on the inner face of the roof structure to both increase roof u-value and provide improved acoustic performance of the high-performance single ply roof finish.

LVL (laminated veneer lumber) beams are used as lintols over larger openings in the new structure, limiting metal usage to straps, screws bolts and gutters.

**Sanna House, Low Road,  
Westmuir, Kirriemuir DD8 5LN**

**Gary Sinclair  
Gary Sinclair Architecture**



## Walker House



The new build house design lies within the Colinsburgh Conservation Area.

The new simply designed house, marries current styles of architecture with traditional building techniques and evokes a style that aims for continuity of the character of the Conservation while introducing an energy efficient environmentally friendly house to the site. The design expresses a modern interpretation of the traditional Scottish rural aesthetic while preserving traditional architectural features.

The new build house benefits from solar power and an air-source heat pump which paired with the high levels of insulation and air-tightness detailing which upon completion the project achieved an EPC rating of 'A' for both energy efficiency and carbon emissions.

**77A Main Street, Colinsburgh,  
Fife KY9 1L**

**Fermin Beltran  
Fife Architects**



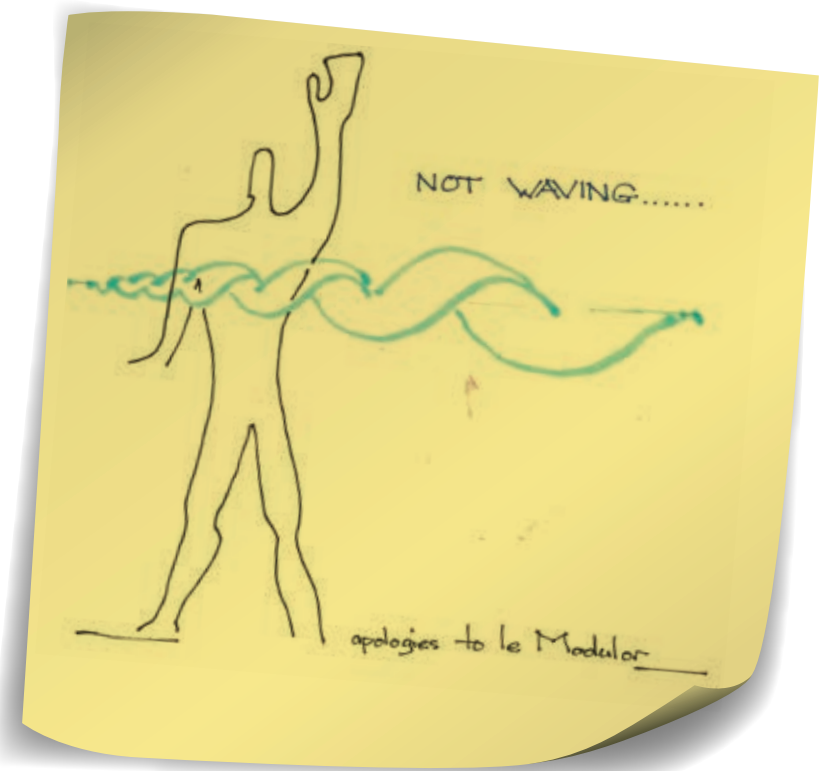
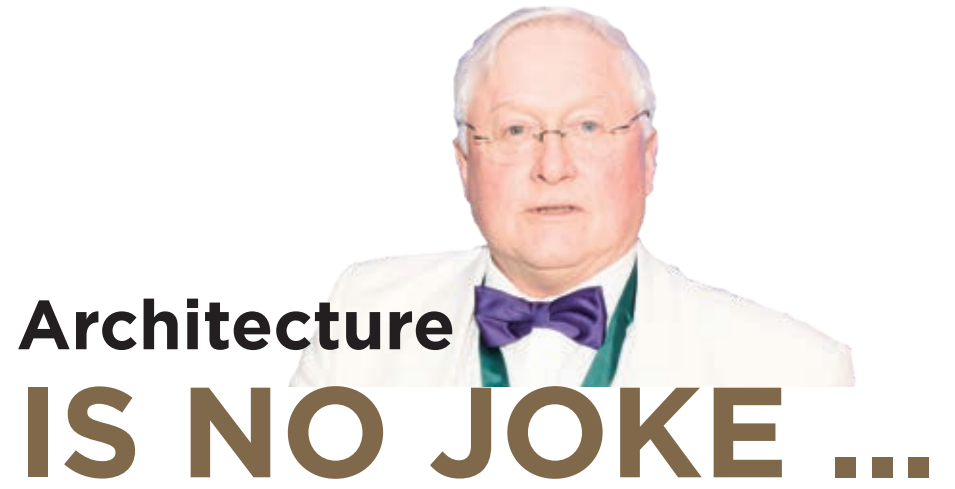

... but it can have a funny side if you look for it!



## DIA Best Student Award

The DIA appreciates It has been a difficult year for both students and staff as they have adjusted to the loss of the creative interactive learning environment that traditional studio work and tutoring provides. It was pleasing therefore to see the high quality of work on display as we assessed the submissions for the DIA Best Student Award. After much discussion we narrowed the projects down to two very different schemes, but found it impossible to separate the two projects. So, for the second year running, the DIA decided to present the Best Student Award to two people. This year the award for DIA Best Student was given jointly to Lewis Chalmers and to Mahnoor Habib.



### Lewis Chalmers

The DIA were impressed by Lewis's design for a new rural college campus on the outskirts of Dundee. Linked to the city centre by a green corridor the project is a well thought out response to the brief creating a diverse, active and sustainable campus well integrated into its landscape setting. The design of the buildings demonstrate a rigorous understanding of spatial hierarchy, material use and construction, all clearly and logically presented.

### Mahnoor Habib

Taking a run down area of Perth Mahnoor has developed a new urban mixed use neighbourhood that is inspired and rooted in Perth's historical urban typologies. The DIA appreciated Mahnoor's understanding of the richness and complexity of society and how this was manifested in the submission. The flexibility within the design for individual expression, adaptability and sustainability, were seen as particularly pertinent.





## **DIA-Logue Education Update 2020-21**

**During a very challenging year, DIA Council representatives have undertaken a range of completely on-line engagement with University of Dundee staff and students as well as some other professional insight engagement with other less local institutions.**

As well as direct DIA council membership from university staff members actively engaged in the delivery of architectural education; other council members have engaged in assisting with Professional Practice and Design course delivery, and undertaken 'meet the Architect' Q and A sessions, bringing students and local practitioners together for some lively and interesting conversation and debate on the path through education and into live practice.

Council representatives were also part of the RIAS Education Working Group (EWG), this body worked online throughout 2020, with a range of participants at all levels of the profession and education from throughout Scotland. This EWG's main achievement was the creation and delivery of a nationwide 'Data Gathering' exercise to take a snap shot of opinions on the best ways for the RIAS to maintain and improve the quality of Architectural Education in Scotland. The EWG showed the huge benefit to be gained from on-line discussions in the covid era, where geographically diverse viewpoints from the full range of students, academics and practitioners was heard by all participants.

The EWG is now requesting nominations for membership of a reformed Education committee reporting directly to RIAS Council.

DIA Council continues to liaise with the University of Dundee, including continued sponsorship and judging of the Best Final Year Student prize, as well as the resurrection of a Student Group Work prize for the forthcoming academic session.

## **Architects Invited to Shape Future of the Profession**

### **Open consultation - Review of Architects Regulation**

The UK Government has announced for a call for evidence for those working in the architectural and built environment professions on the Review of Architects Regulation. (i.e It is not only Architects getting the opportunity to comment on Architects Regulation.)

The DIA therefore encourages its members to engage with this opportunity to shape the future of the profession and contribute to a wholesale review that will consider modernising regulation, improving diversity and upholding our global reputation in Architecture.

The RIAS welcomes a focus on how the profession can become more diverse and accessible, whether the current regulatory regime and regulation of Architects can support a more sustainable built environment and how Government can promote innovation in the sector.

The RIAS and its Committees will collate comments and respond on behalf of members and will share a draft in due course.

The RIAS would therefore value any comments that you may have. For instance - should we continue to protect the Title or should it be protection of Function?... Is the ARB fit for purpose?...etc.

**Please respond to: [info@rias.org](mailto:info@rias.org)**

Please mark your correspondence clearly with:  
**"Open Consultation - Review of Architects Regulation".**

**This opportunity to shape the future of the profession will close at 11.45pm on 8th November 2021 so do not delay!**





## Stobswell 'Pocket Parks'

### Spaces for People, Stobswell Pocket Parks on Eliza Street and Craigie Street

The project in Stobswell was Phase 2 of Spaces for People, funded by Sustrans, which aimed to create more space for people walking, wheeling and spending time outdoors during the global pandemic. UNESCO City of Design Dundee partnered with Dundee City Council to initially deliver the Union Street project and its success led to DCC taking a co-design approach to Phase 2. Led by the UNESCO team, lead officer Annie Marrs and Poppy Jarratt, professional designers were brought onboard to support the process. Myself, an architectural designer, and Louise Kirby, a local designer and illustrator were brought on to the core design team.

To support the co-design process, we worked with Service Design Academy who ran two online workshops with members of the community. Rather than bringing the community in later during a consultation process, their ideas and wishes for Stobswell gathered in these workshops were the focal point for the project. The community were incredibly proud of Stobswell, and spoke often about emphasising places and qualities it had, its 'jewels'. Bringing in more colour, art and greenery to Stobswell were also mentioned frequently in these workshops, which gave us our starting point.

After the workshops, the team looked at where we could reclaim parts of the road and which parts of the street could facilitate better walking, wheeling and spending time safely outdoors. Walking routes and travel distances, and noted areas of interest, existing public art and greenery were mapped to get a clearer picture of Stobswell. Once the potential areas, Eliza Street and Craigie Street, were selected for

development into pocket parks, draft proposals were presented to the community for feedback and input.

Next, Old School Fabrications were brought on to the team to design and build the street furniture. Echoing circular public art on the gable end on Craigie Street, OSF designed robust planters and benches using precast concrete rings, either built out to form planters or fitted with larch bench tops, often combined together to make longer, non-traditional playful seating forms. Despite the temporary nature of the project, it was important to build street furniture that would be robust enough to sustain any time frame and not fall apart while it was still a part of the street fabric in Stobswell. Planting, proposed by Nick Burton Garden Design, was selected for how it would work all year round.

Simultaneously, Louise developed a pattern identify for both streets, using colour and motifs that represented the local area. Each pocket park had a different identity, but with similar colours, uniting the scheme.

The parks are currently still a work in progress, as the road painting is still due. Restricted by the cobbled street, Eliza Street will receive a colourful patterned crossing at the edge of Albert Street, visually drawing passersby in from the high street. Craigie Street will receive 2D circles spaces out on the pedestrianised section amongst the seating, once again inspired by the brick relief pattern in the gable end.

Fiona Canavan



# Report on RIAS Planning Committee

The committee has met quarterly by Zoom and the following issues have been addressed.

## National Planning Framework (NPF4).

The document has been published, discussed at committee and observations have been lodged to the Scottish Government. NPF 4 will come into force later this year.

## Key issues for the architectural profession are:

Embracing protection, management and planning for nature especially in major housing and other developments; biodiversity and climate awareness, rewilding of open spaces including private gardens, city parks etc.

## Carbon neutral infrastructure (Aim).

Community planning involvement and encouragement of greater use of Community Councils.

The concept of a 20minute principle based on local community provision (shops, school etc.)

“Placemaking”, Town Centre Reviews, “Caring Places” and Local Place Plans.

New Permitted Development Rights, this particularly affects rural areas as there is almost a “Carte Blanche” provision to alter and develop existing farm buildings and other derelict properties. The Committee have advised the Government that some control is necessary.

## Design:

The pre-planning process should be utilised as a tool to evaluating and where necessary, building and landscape design proposals.

In relation to major housing developments A D+S have been advising developers on proposals in relation layouts and architectural design.

SEPA have recently introduced new legislation in relation to pollution control, which will affect development at all scales.

It has been highlighted that in the case of Design and Build what is built does not necessarily match the Architects approved proposals but is outwith their control, although they may well be asked to carry the blame. This has also been raised at DPEA stakeholders’ meetings which have been attended by Hugh Crawford and myself on behalf of RIAS.



## DPEA Stakeholders:

We have had several virtual meetings with DPEA over the lock-down period.

Issues raised in relation to appeals to the Scottish Government can be summarised as follows:

A wide range of statistics in relation to different types of development subject to Appeal were produced but a success rate of around 44% would apply to the majority of building proposals.

Reporters have suggested that the majority of complaints are submitted by or on behalf of third parties and encouragement should be given to applicants or their agents to attempt to resolve issues before applications are submitted.

During discussion, it was suggested that more planning might be given coverage in architectural courses.

Finally, the current panel of Reporters come mainly from outwith the architectural and design professions (e.g. legal). The RIAS Planning Committee has discussed this issue and at the DPEA Stakeholders meeting we offered the possibility of basic Design training and appreciation by RIAS to interested reporters.

Joe Dagen.



## **A Room That Is Not There**

**I sit upon an upright chair  
Inside a room that is not there.**

**Holding an architectural plan  
near my garden fence, I try to scan**

**the shape of all that I shall see  
next year from my new library.**

**I draw a window in the air  
and, leaning on its sill, I stare**

**at apple trees, the crescent bed  
and half the herbs beside the shed.**

**I feel the sun's low winter arc,  
June foxgloves, autumn's burnished dark,**

**and see how you are doubly right  
and books are nothing without light.**

**2021 Robin Bell, Poet & Broadcaster**

## **Coming to a sky near you: Swifts!**

**These aerial acrobats visit Scotland from their wintering grounds in Africa for just over three months each summer – arriving in early May and leaving in August. They are a familiar sight in towns and villages on fine summer evenings when they gather together in ‘screaming’ parties, flying at speed around the buildings where they nest, before ascending into the twilight sky to sleep on the wing. These remarkable birds also eat and mate on the wing, never perching on wires like swallows or house martins; in fact the only time they land is when raising their chicks.**

Originally a tree nesting species, swifts now depend almost entirely on our buildings for nest sites, using gaps in stonework, behind down-pipes, or under the guttering.

They are faithful to one nest site and return year after year with the same mate. Unlike swallows and house martins, swift nests have no external structure and indeed consist of little more than a few feathers and straw glued together with saliva, which causes no structural damage to property.

Sadly, numbers of this summer icon are falling. Nests are being lost due to over-zealous renovation and demolition, new buildings deny access to swifts and when a changing climate is added to the mix, the result: Scotland's swift numbers have fallen over 60% in the last twenty years.

As Architects we can however help make a difference for swifts by considering how we can accommodate their nesting requirements into the way we renovate and design new buildings. There are a number of commercially available “swift boxes” which can be added to an existing building, or alternatively incorporated within the design of new buildings.

Information on how to support swifts can be found at [www.swift-conservation.org](http://www.swift-conservation.org) or by contacting Daniele Muir of Tayside Swifts on [dmuir@taysideswifts](mailto:dmuir@taysideswifts)





# COP 26 Conference!

The DIA are liaising with the RIAs and other Chapters to deliver a series of events for the COP26 Conference throughout the country to bring awareness of the impact of rising water levels on our coastal cities, towns and rural areas.

For this we are developing a cycle route, shopfront exhibitions and tidal markers to raise awareness.

Dundee is to be the main Climate Beacon focus within our Chapter area and we have joined Dundee's COP26 Working Group who are co-ordinating a city wide approach. There is going to be a launch event at Slessor Gardens on Sunday 26th September of which the DIA will be there with a stall to promote sustainable architecture.



The DIA are also preparing a series of Sustainability themed CPD events over the 6 week period culminating in a half day conference. These events will be open to the wider public and will also be promoted through the Dundee COP26 website list of events. We hope these events will raise many questions and discussions as to what the Architectural profession can do to reduce the threat of the climate crisis.

We will be putting out a questionnaire on 'How can Architects Improve the Sustainability the Built Environment' in the coming weeks to get this discussion started.

If any of our members have any suggestions for talks and other events that we should be doing in the lead up to and during the COP26 conference please do not hesitate to contact us at [events@dia-architects.com](mailto:events@dia-architects.com)

## CPD / COP26 talks for October /November 2021

Confirmation of these events will be posted on the website as soon as they are ratified.

Talk	Topic / Buildings	Speaker
<b>Community Projects</b>	Leaf Room	Jonathan Reeve / Voigt Architects
	Community Fridge	Jon Frullani / Frullani Architects
	Stobswell 'Pocket Parks	Fiona Canavan
	Larick Centre Tayport	Tony Gowland
<b>Sustainability Award Winner</b>	Urban Woodland Passive House	Kirsty Maguire
	Baird House Auchterhouse	Peter Gunning
<b>Passive House - Post Occupancy Evaluation</b>		
<b>Low Carbon Retrofit</b>	Discovery Centre	Ged Young / Aim Design
	Easter Fernie School House	Fermin Beltran / Fife Architects
<b>Building in SSSI areas</b>	(To be advised)	Paul Higginson / Arc Architects
<b>Re-using Old Buildings</b>	Waters Edge	Ryan Cathro / NRS Architects
	Westward Works	McGinlay Bell Architects
<b>Recycling &amp; Circular Economy</b>	Seaton Park Community Leisure Centre	Jonathan Reeve / Voigt Architects
	Zero Waste	Clive Bowman / Zero Waste Scotland
<b>Community Housing Project</b>	Garochy Trust	Stephen Lamb / AB+C Architects
<b>HES Retrofit Guide</b>	Works by HES	Moses Jenkins / Historic Environment Scotland
<b>Climate Crisis on the Island of Tonga</b>	Architectural Solutions to the...	Advisement of other participant from Tonga)
	Making of the Documentary Film	Anthony Baxter / Montrose Pictures



## New DIA Website



**The DIA launched their brand new website just in time for the AGM in March - please check it out at [www.dia-architects.com](http://www.dia-architects.com). The intention is that the new website will be our platform to showcase the annual DIA awards. After a break in 2020 due to Covid 19, the DIA intend to re-start our annual awards this autumn.**

As well as the awards, the DIA website will also be used to disseminate local information - such as the DIA CPD programme, other DIA events such as the AGM, the annual pub quiz, the student awards and any other events that we hear about in the Dundee area and think may be relevant to Architects.

As DIAlogue is now made available to members in a digital format. This DIAlogue and our back catalogues are available to download from the website. We also now upload our monthly DIA Council minutes on the website.

We would like people to use the site as much as possible, so if any Architect has a notice or request, or is looking to advertise for a job vacancy in the DIA area, we can post this on the website.

Please have a look and get in touch if you have any comments to [president@dia-architects.com](mailto:president@dia-architects.com) - all feedback welcome!

## Conservation Matters

**The RIAS Conservation Committee has had a busy year.**

The Committee has provided feedback to the RIAS Sustainability Working Group position paper on Decarbonising Construction and some of the statements relating to retrofit. The paper suggests how net zero carbon could be introduced into the Building Standards.

The Conservation Committee considers that the methods used to assess how existing buildings perform such as SAP are inappropriate. The existing tools need to be radically improved or other energy assessment tools need to be allowed to allow for a better demonstration of how current buildings perform. Currently performance is underestimated which can suggest major improvement works are required, which may not actually be the case.

RIAS conservation committee have been looking for examples of technical solutions in renovation or repurposing works to old buildings that have satisfied building control officers as part of building warrant applications. If members have examples they would like to share with the Conservation Committee these will be gratefully received. It is hoped that these will inform a HES paper.

The Conservation Committee is keen to encourage application for Conservation Accreditation by members and have introduced a mentoring programme to help and encourage Architects who are considering preparing an application. Please contact the RIAS if you wish to utilise this opportunity.

The RIAS has partnered a number of CPD events around conservation matters & some of these are available to view on RIAS on demand: Conservation CPD. [www.eventbrite.co.uk/e/rias-on-demand-conservation-cpd-tickets-162271976851](http://www.eventbrite.co.uk/e/rias-on-demand-conservation-cpd-tickets-162271976851) Keep an eye out for details of the full day Conservation CPD that is planned to be held at the Engine Shed, Stirling later this year.

Historic Environment Scotland are preparing an undated & extended version of HES's Energy Retrofit Guide in Traditional Buildings to replace Short Guide 1. The Conservation Committee has provided feedback on the draft as part of wider liaison on joint interests. The original 'Short Guide 1' publication can be viewed here [www.historicenvironment.scot/archives-and-research/publications/publication/?publicationId=179c1909-3679-4486-9583-a59100fa98c1](http://www.historicenvironment.scot/archives-and-research/publications/publication/?publicationId=179c1909-3679-4486-9583-a59100fa98c1)





dundee institute  
of architects



Follow the DIA:

[www.dia-architects.com](http://www.dia-architects.com)

 [facebook.com/DIAdundee](https://facebook.com/DIAdundee)

 @DIAdundee